



CDT Five

CD TRANSPORT

OWNER'S INFORMATION

! IMPORTANT SAFETY INFORMATION !

HUMIDITY: DO NOT STORE OR OPERATE THIS UNIT IN AREAS OF HIGH HUMIDITY, OR IN CLOSE PROXIMITY TO WATER/DAMPINESS. DO NOT EXPOSE THE UNIT TO LIQUID.

EARTHING: THIS PRODUCT MUST BE EARTHED – ENSURE THAT THE MAINS SUPPLY CABLE IS EARTHED.

SHOCK: INTERNAL OPERATING VOLTAGES ARE LETHAL! DO NOT REMOVE THE TOP COVER. DO NOT ATTEMPT TO REPLACE THE FUSE WITHOUT DISCONNECTING THE UNIT FROM THE MAINS SUPPLY.

SAFETY COMPONENTS: INTERNAL FUSES AND OTHER SAFETY COMPONENTS ARE LOCATED INSIDE THIS UNIT IN ACCORDANCE WITH BS 60065 REQUIREMENTS.

IN THE EVENT OF SAFETY COMPONENT FAILURE, THEY MUST BE REPLACED WITH THE SAME PART TYPES ONLY. SUCH REPLACEMENT MUST BE CARRIED OUT BY A QUALIFIED SERVICE TECHNICIAN.

PRECAUTION

Never touch the power cord with wet hands.

Always pull the power cord out by the plug, not by the cord.

Never expose the system to rain, moisture, excessive heat and magnetism.

Never let an inexperienced person repair or reassemble the unit.

Never put anything, especially metal, into the unit.

Never place excessive weight on the unit.

Always remove compact disc and CD clamp out of the unit before carrying or transportation.

POWER REQUIREMENTS

Power requirements for electrical equipment differ from area to area. Please ensure that your unit meets the power requirements in your area. The power requirement for your transport is marked on the serial number plate on the rear panel.

If you are in doubt, please contact your dealer before plugging the unit into the mains!

CE DECLARATION OF CONFORMITY

We declare under our sole responsibility that this product is in conformity with the following standards or standardized documents:

BS EN 60065 in accordance with the regulations 73/23/EEC, 89/336/EEC (from 1st January 1997).

CE 94

Peter Qvortrup
Director
Audio Note (UK) Limited
25 Montefiore Road,
Hove,
East Sussex
BN3 1RD
United Kingdom
Tel: +44 (0)1273 220 511
Fax: +44 (0)1273 731 498

WARRANTY AND SERVICING

Audio Note warrants this product free from defects in materials and workmanship for 2 years from original date of purchase from an appointed Audio Note dealer. The valves are warranted for 3 months. In the event that your Audio Note product requires servicing, please contact your Audio Note dealer. If the equipment needs to be shipped, please use the original packaging and include a copy of the sales purchase, with a note, explaining in as much detail as possible, the problems that you are experiencing with the unit.

Any modification not authorized by Audio Note will invalidate this warranty.

If you require technical support, new valves or have any questions, please direct them to your Audio Note dealer first or contact us directly.

Customer Support:

Audio Note (UK) Limited,
25 Montefiore Road
Hove, East Sussex,
BN3 1RD,
United Kingdom
Tel: +44 (0)1273 220511
Fax: +44 (0)1273 731498
Email: info@audionote.co.uk

CLASS I LASER PRODUCT

This product contains a low power laser device. To ensure continued safety, do not remove any covers or attempt to gain access to the inside of the product. Refer servicing to qualified personnel.

Make Your Contribution to Protect the Environment

Used batteries with the ISO symbol for recycling, as well as small accumulators (rechargeable batteries), mini-batteries (cells) and starter batteries should not be thrown into the dustbin. Please leave them at an appropriate depot.

This equipment conforms to No. 62/499/EEC, 87/308/EEC standard.

TABLE OF CONTENTS

1	PRECAUTIONS
3	UNPACKING & INSTALLATION
4	CONNECTION
5	OPERATIONS
7	PROGRAMMING
8	TROUBLESHOOTING GUIDE
	SPECIFICATIONS

GENERAL

Congratulations on your purchase of the Audio Note *CDT Five* CD transport.

Audio Note is highly critical of the digital medium as presented by compact disc; we sincerely hope that you too will find this transport breaks free from the 'digital mould' that we are all so accustomed to, and so open a new window on your CD collection.

Please read over this manual carefully in order to obtain the best possible performance and longevity from your transport.

UNPACKING & INSTALLATION

1.) Please take care when unpacking the *CDT Five*. We recommend that you store the packing materials in case the unit requires shipping at a later date.

2.) Next, select a suitable location for the unit, for example, a dry and dust-free area which is not exposed to direct sunlight. Place the CD transport on level flat surface free from vibration.

3.) Please remove all 3 transit screws, located on the top of the *CDT Five* and marked with yellow washers, to release the sprung sub-chassis.

4.) For best results the CD transport and the sub-chassis should be properly leveled. Please make sure that the *CDT Five* sits on a leveled surface and then adjust the three chassis adjustment screws with the 4mm allen key provided. Turn the screws clockwise to raise the suspension and anti-clockwise to lower it. The distance between rails of sliding door and borders of sub-chassis should be about 5 mm. The sub-chassis should not knock the main chassis when pressed down and released. Turning the screws anti-clockwise too much is unallowed and can cause the damage to the unit.

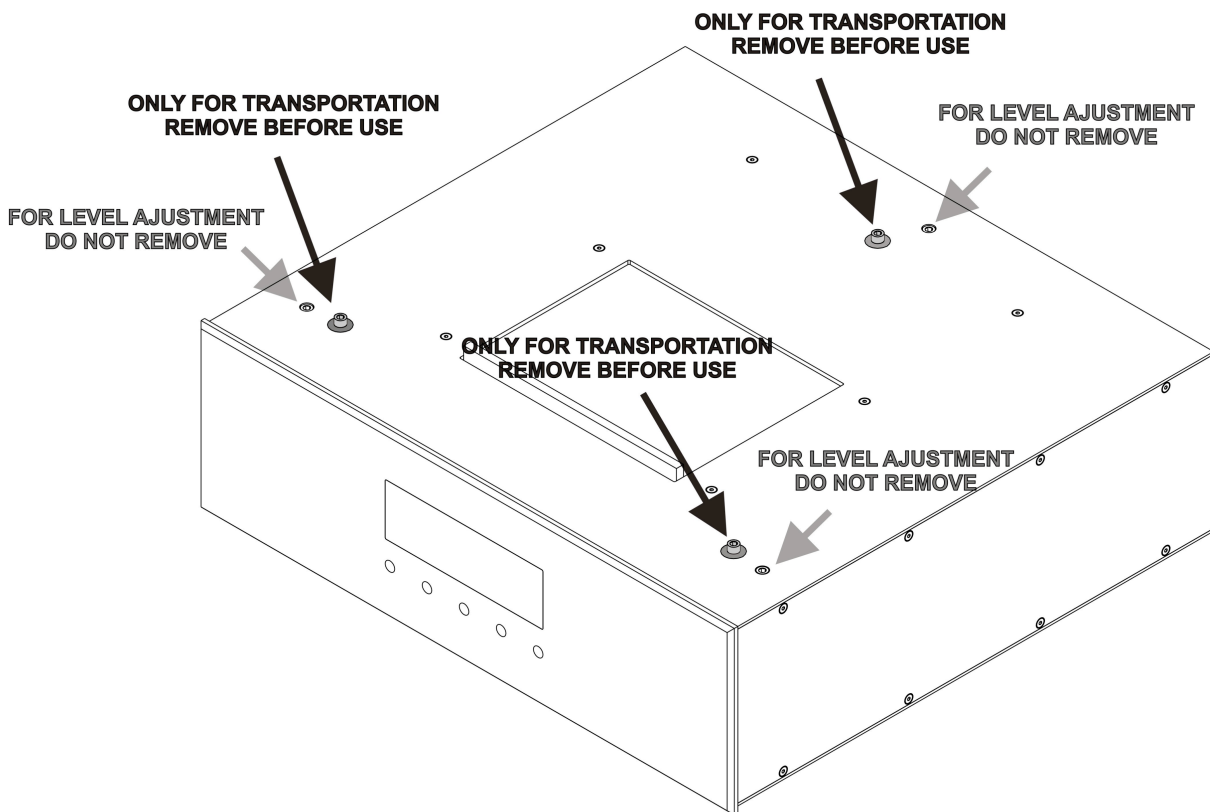

Connections:

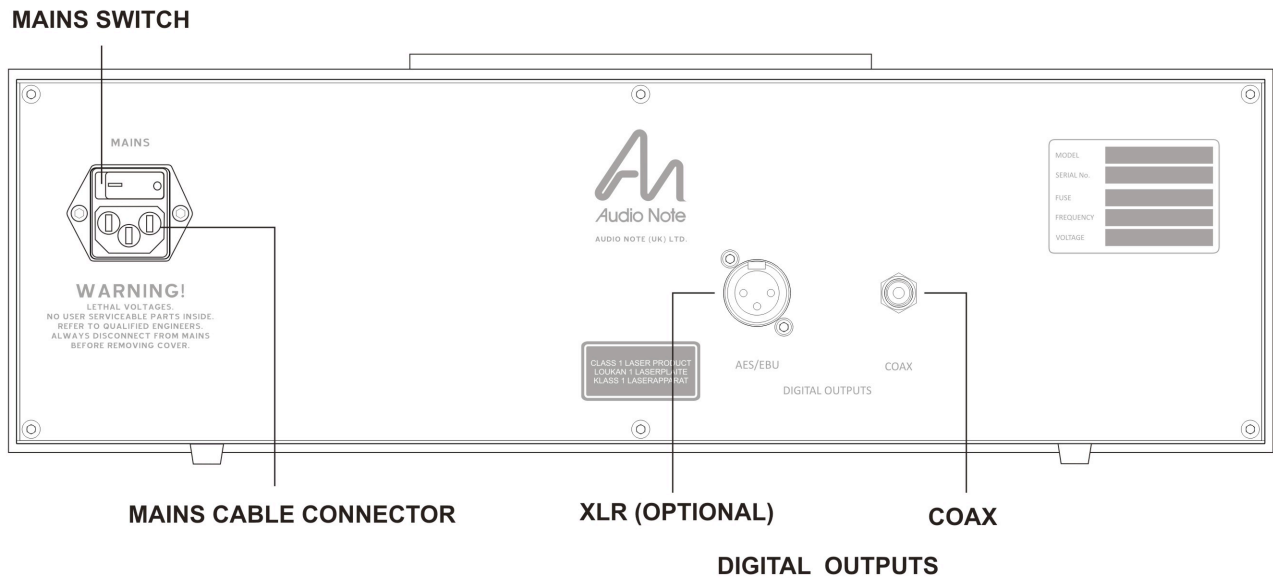

Connectors on the back of CDT Five unit provide a digital output for connection to your DAC via your digital interconnect with RCA connectors. XLR connection is optional, please contact your Audio Note dealer if you require it. Your dealer can advise on suitable type and quality of cable eg: - Audio Note PALLAS or digital SOGON50 are excellent choices.

Mains connector: An IEC power connector is available for connection to mains using the supplied mains cable. For further improvement in sound, we recommend to use Audio Note SOGON mains cable.

The transport's sonic performance will start to improve as the internal parts 'bed' in. The transport requires about 400-600 hours of operation before the bedding in process is complete.

IMPORTANT INFORMATION

Compact disc transports have built-in error compensation circuits to correct minor manufacturing defects on a disc. In some cases, defects on the disc, which are too large for the error compensation circuits to handle, may cause the CD player to skip some tracks during playback. If this problem occurs, play a new disc, normal playback of the new disc indicates that the previous disc is damaged in some way. However, if the problem continues, it is best to have the unit serviced.

LOADING THE DISC

Please open the sliding door on the top of *CDT Five*. Put the disc on the spindle and secure it with the supplied disc clamp. Close the door.

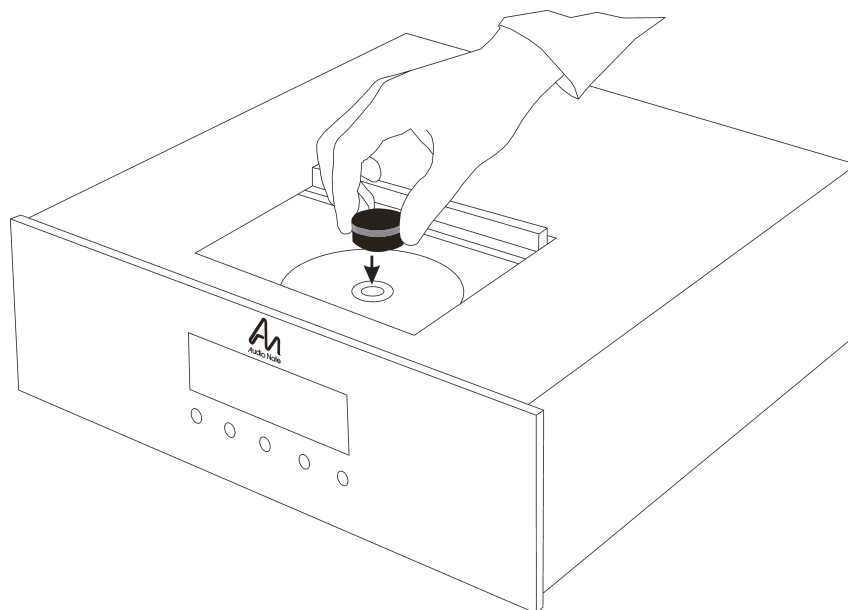

OPERATIONS

VIA BUTTONS LOCATED ON THE FRONT PANEL

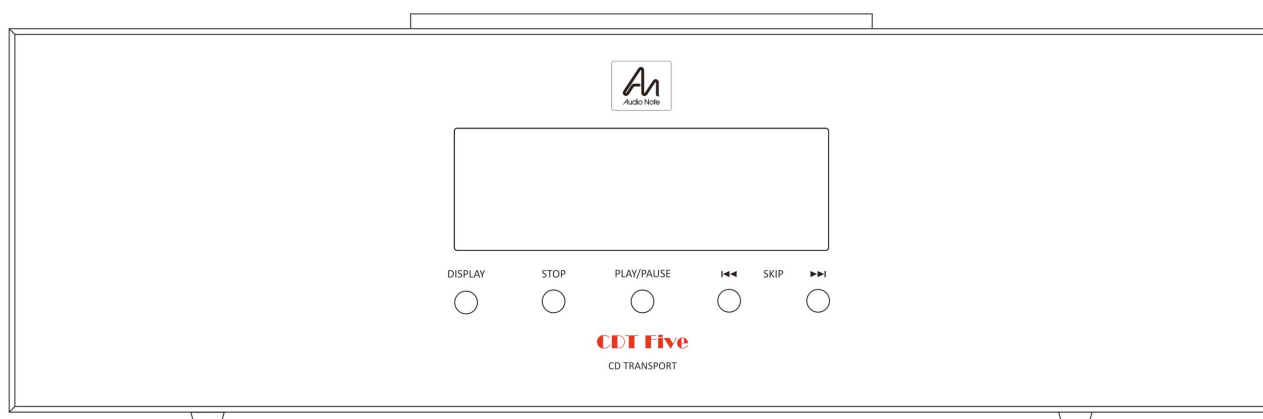

PLAY/PAUSE Press this button to play a disc.
Pressing this button again will pause playback.
Press the button again to resume playback.

STOP Press this button to stop playback.

SKIP (⏮ ⏭) Press these buttons to go to the previous or the next track.

DISPLAY

Press this button to change the intensity of display or to turn it on/off.

VIA REMOTE CONTROL

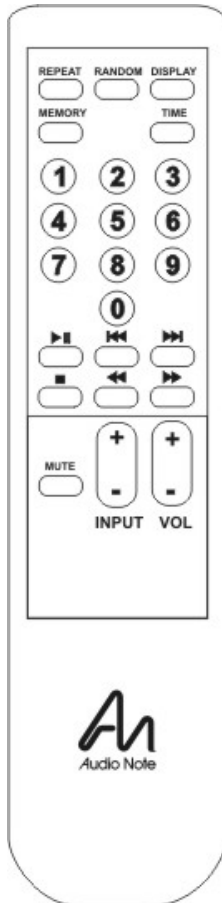

The batteries for the remote control handset for the CDT Five are not included. Please purchase them (high quality AA batteries are recommended) and fit into the handset before operating the remote control. Please ensure that the batteries are inserted correctly.

PLAY/PAUSE (▶ ||) - Press this button to play a disc. Pressing this button again will pause playback. Press the button again to resume playback.

STOP (■) - Press this button to stop playback.

SKIP (◀▶) - Press these buttons to go to the previous or the next track.

SEARCH (◀▶) - Press these buttons to cue or review a track.

To reverse (review) a track, hold down the SEARCH ◀ button. To cue (fast forward) a track, hold down the SEARCH ▶ button.

MEMORY - Use the Memory button for programming and reviewing programs.

PROGRAMMING

You may select a number of tracks and store them in the memory in the desired sequence. The player will then play back only your selection of tracks in the selected order.

- 1 Press the MEMORY button. 'MEMORY' will appear on the display.
- 2 Press the CD SKIP or numbered buttons - To select the desired track to be stored.
- 3 Press the MEMORY button - The track is now stored in the memory.
Repeat steps 2 and 3 to complete programming.
- 4 Press PLAY to listen to the programmed tracks.
- 5 Press STOP once to stop playback.
- 6 Press STOP second time to clear programming.

A maximum of 32 tracks may be stored.

A particular track in your selection may be replaced with a new one if the original selection was made in error. Simply store the new track in the program number to be replaced.

NOTE: Programming may not be made during playback.

TIME button. Press this button to see the elapsing or remaining time of the CD (Play mode only). Press the TIME button and select the desired TIME DISPLAY for CD playback.

Each time this button is pressed, selection is as follows:

"EACH REMAIN"	the elapsed playing time for the current track
"TOTAL"	the total elapsed playing time
"TOTAL REMAIN"	the remaining playing time for the current track

REPEAT button. Press this button to listen to the music repeatedly. Press once to repeat the entire disc. Press twice to repeat the track being played.

RANDOM button. Press this button for random order playback.

NUMBERED buttons. A particular track may be selected for playback by using these buttons. Example:

To play track No. 3, press the button "3" once.

To play track No. 14, press the buttons "1" and "4" in succession.

To play track No. 20, press the buttons "2" and "0" in succession.

DISPLAY button. Press this button to change the intensity of display or to turn it on/off.

Press the DISPLAY button once to reduce the intensity of the display. Press the DISPLAY button twice to turn the display off. To turn the display on, please press DISPLAY button once again.

TROUBLESHOOTING GUIDE

Refer to the relevant sections in the manual for remedy suggestions.

SYMPTOM

No sound from the CD player.

Playback does not start.

"NO DISC" appears.

Playback does not start from the first track.

CHECK POINT

Correct input is not selected on the amplifier.

The disc door is not fully closed.
The disc is dirty or scratched.
The disc is upside down.
The player is in the PAUSE mode.
Moisture condensation has caused the unit to operate incorrectly.

There is no disc loaded or the disc is loaded incorrectly.
The disc clamp is not in place.

The player is in the PROGRAM or RANDOM mode.
Press the STOP (■) button to cancel the program mode or RANDOM button to cancel random mode.

SPECIFICATIONS

Optical pick-up:	3 beam laser
Semi-conductor laser:	780 nm
Power source:	AC 100-120V/220-240V 50/60 Hz
Fuse:	220/240V 800 mA Slow blow (T type) 100/120V 1.6A Slow blow (T type)
Dimensions: (incl. connectors)	445 (W) x 142 (H) x 428 (D) mm
Weight:	22kg
Max. power consumption:	60W